

TYLNEY HALL



Rotherwick Hook Hampshire



MEETINGS, INCENTIVES AND EVENTS





Historic estate in the heart of Hampshire



Tylney Hall holds considerable architectural and historical interest. The Hall, which dates from 1898, served as a hospital during the First World War and later as a private school. Now, this magnificent Grade II listed hotel, set in 66 acres of manicured historic gardens, including water gardens designed in the style of Gertrude Jekyll, woodlands and lakes, provides an exceptional mix of traditional and contemporary, the first reflected in the hotel's comfort, character and service, the second in the modern accoutrements demanded by today's business delegates.

Surrounded by rich rolling countryside and commanding the longest uninterrupted view of Hampshire along its redwood-lined Vista, Tylney Hall is easily accessible from London, major motorways and international airports.





Elegance and traditional luxury



The elegance and traditional luxury of Tylney Hall is immediately apparent in the rich walnut panelled reception hall. The Italian and Grey Lounges, with their individual styles and welcoming fires, provide a peaceful oasis for a coffee or afternoon tea break between meetings or for a relaxing chat with colleagues.

Amongst the 112 spacious and exquisitely furnished bedrooms and suites, we are sure there is a room to perfectly suit your needs. There are suites with four poster beds, some with spa baths and others with breathtaking views across sweeping lawns. In the historical garden lie the Orangery, Conservatory and Estate Houses, all beautifully furnished and providing complete privacy.

After a demanding day, a restorative drink can be enjoyed in the Library Bar before dining in the glass domed Oak Room Restaurant. The excellent cuisine and wines, piano accompaniment, views of the immaculate gardens and general ambience make dining in this award winning restaurant an absolute delight.



Board meetings to grand receptions



Vital elements to consider when planning a successful corporate event or private celebration are location and versatility of the venue and the quality of support and service. Tylney Hall meets all the important criteria.

The 12 very individual suites offer superb facilities in splendid surroundings. The magnificent Tylney Suite, a baronial hall with stage and minstrel's gallery, can accommodate a theatre style presentation for 120; the self-contained Hampshire Suite, with its walled garden, private bar and latest technology, comprises three rooms appropriate for a board meeting for eight, a meeting for 70 or a reception for 100. An ideal setting for a wedding reception, dinner or party is the Chestnut Suite, with private en-suite reception area, bar and cloakroom, whilst a number of smaller suites are perfect for syndicate rooms or private events and celebrations.



Spring Hill
— *Spring Hill* —
Avenue
AA
PACIFIC

Speaker at podium

ROOM CAPACITIES

	<i>Theatre</i>	<i>Classroom</i>	<i>Boardroom</i>	<i>Cabaret</i>	<i>U-shape</i>	<i>Private Dining</i>	<i>Reception</i>	<i>Fork Buffet</i>	<i>Wedding License</i>
Tylney Suite	120	70	40	64	45	-	120	-	y
Newnham Suite	20	-	20	-	-	33	25	24	y
Mattingley Suite	40	35	26	-	25	55	60	44	-
Old Basing	-	-	8	-	-	10	-	-	-
Sherborne Suite	20	16	16	-	-	22	-	22	-
Heckfield Suite	35	24	24	-	24	44	-	33	-
Rotherwick Suite	35	20	24	-	24	33	-	22	-
Windlesham Suite	-	-	8	-	-	10	-	-	-
Chestnut Suite	100	50	-	64	36	121	121	99	-
Hampshire Suite									
Sir Lionel Phillips	100	48	34	40	36	77	100	66	-
Major Cayzer	70	30	30	24	30	-	-	-	y
Viscount Castlemaine	-	-	8	-	-	-	-	-	-

Back projection available in the Tylney Suite for all set up styles.

GROUND FLOOR

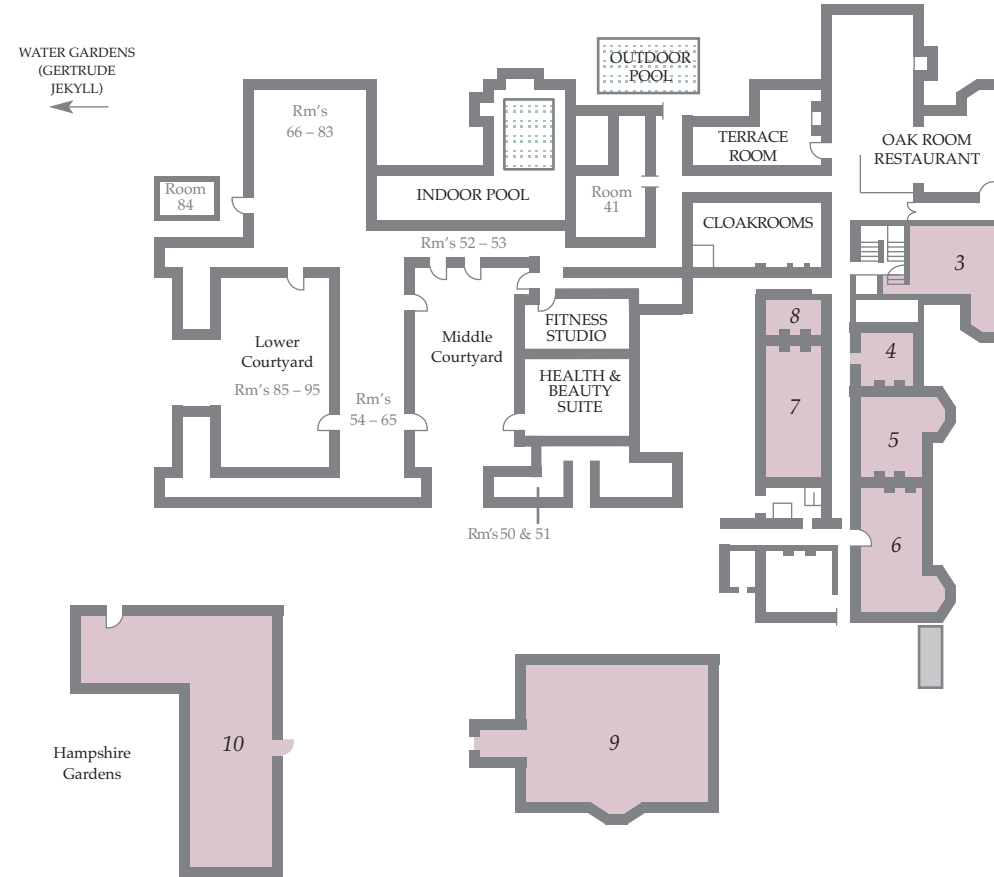

TYLNEY SUITE GROUND FLOOR

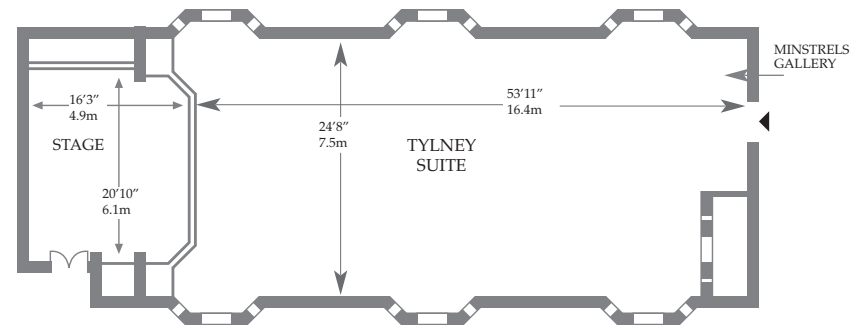

FLOOR PLAN

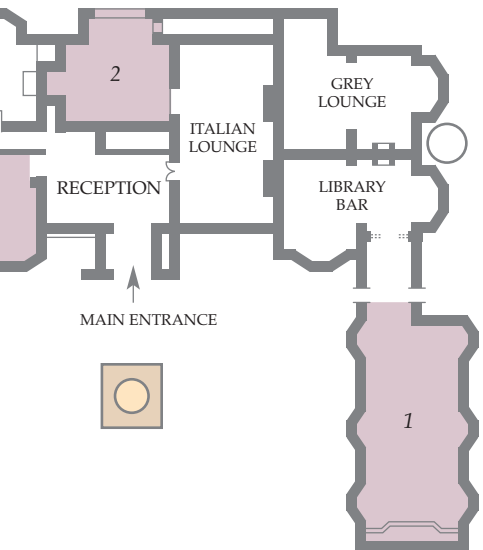

BOATHOUSE LAKE AND ITALIAN GARDENS (SELDON WORNAM)

- 1 TYLNEY SUITE (16.4m x 7.5m)
- 2 NEWNHAM SUITE (8.3m x 6.9m)
- 3 MATTINGLEY SUITE (10.6m x 7.6m)
- 4 OLD BASING (4.45m x 5.2m)
- 5 SHERBORNE SUITE (7.5m x 5.3m)
- 6 HECKFIELD SUITE (10m x 5.3m)
- 7 ROTHERWICK SUITE (9.72m x 5.4m)
- 8 WINDLESHAM (5.4m x 4.8m)
- 9 CHESTNUT SUITE (12.37m x 13.1m)
- 10 HAMPSHIRE SUITE comprising Sir Lionel Phillips (14.7m x 6.8m) Major Cayzer (14.5m x 4.9m) Viscount Castlemaine (4.9m x 3.7m)

Suite Dimensions: length x width

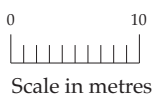

CHESTNUT SUITE GROUND FLOOR

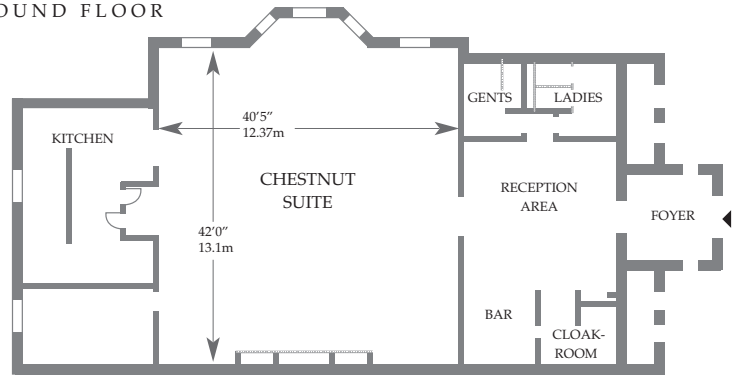

TECHNICAL INFORMATION

	Controls in Rooms	Blackout	Natural Light	3 Phase	13 Amp Sockets	Wifi	Broadband	TV Aerial	Telephone Points	Fax Line	Air-conditioning
Tylney Suite	y	y	y	y	18	y	y	n	8	y	n
Newnham Suite	y	y	y	n	8	y	y	n	3	n	n
Mattingley Suite	y	y	y	n	8	y	y	y	3	y	n
Old Basing	y	y	y	n	8	y	y	n	6	y	n
Sherborne Suite	y	y	y	n	8	y	y	y	5	y	n
Heckfield Suite	y	y	y	n	8	y	y	n	5	y	n
Rotherwick Suite	y	y	y	n	8	y	y	y	5	y	y
Windlesham Suite	y	y	y	n	6	y	y	n	3	y	y
Chestnut Suite	y	y	y	y	24	y	y	y	10	y	n
Hampshire Suite											
Sir Lionel Phillips	y	y	y	n	24	y	y	y	12	y	n
Major Cayzer	y	y	y	n	24	y	y	y	12	y	y
Viscount Castlemaine	y	y	y	n	18	y	y	y	6	y	n





Versatility and style for any event



We have experienced Event Co-ordinators to ensure the venue you select best meets the requirements of your occasion and that any presentation aids or technology to which you may need access are readily at your disposal. Delegates and organisers wishing to enhance their event can take advantage of the Tylney Hall Experience to give their function that 'added edge'.

If you wish to add sparkle to your evening entertainment, we can suggest a range of original and imaginative themes such as a rhythm and blues concert, guest speakers from the world of sport or journalism or a casino night and if you require a complementary themed menu for your evening, our Executive Chef will be delighted to advise and create.



Team sports and activities



Time for leisure and relaxation is an essential item on the agenda and should be planned well in advance of your event. Tylney Hall is the ideal setting and base from which a wide range of motorised and sports activities can be organised including off-road racing, archery, clay pigeon shooting, falconry, hot-air ballooning, treasure hunts and team building exercises. Helicopter flights and corporate yacht charters can also be booked on your behalf.

For the golfer, there is a challenging 18 hole course adjoining the hotel grounds and to keep in trim, there are jogging trails, all weather tennis courts, heated outdoor pool and croquet lawn. If you wish to explore the surrounding Hampshire countryside, mountain bikes can be hired and walking maps and guides are available.







Energetic pursuits or pure relaxation



The indoor leisure facilities at Tylney Hall are designed to meet the many and varied requirements of our guests. You can take a swim in the temperature controlled indoor pool, work out in the fully equipped gymnasium, relax in the whirlpool or saunas or make a break in the snooker room.

Set around a charming courtyard, complete with fountain, the health and beauty suite is the perfect place to be pampered after a demanding day. The five treatment rooms, manicure and pedicure studio, offer a wide range of exclusive facial, body and beauty treatments. Tylney Hall have created a bespoke range of Signature Treatments combining different styles and techniques from around the world producing a complete unique spa experience.

TYLNEY HALL



How to get to Tylney Hall

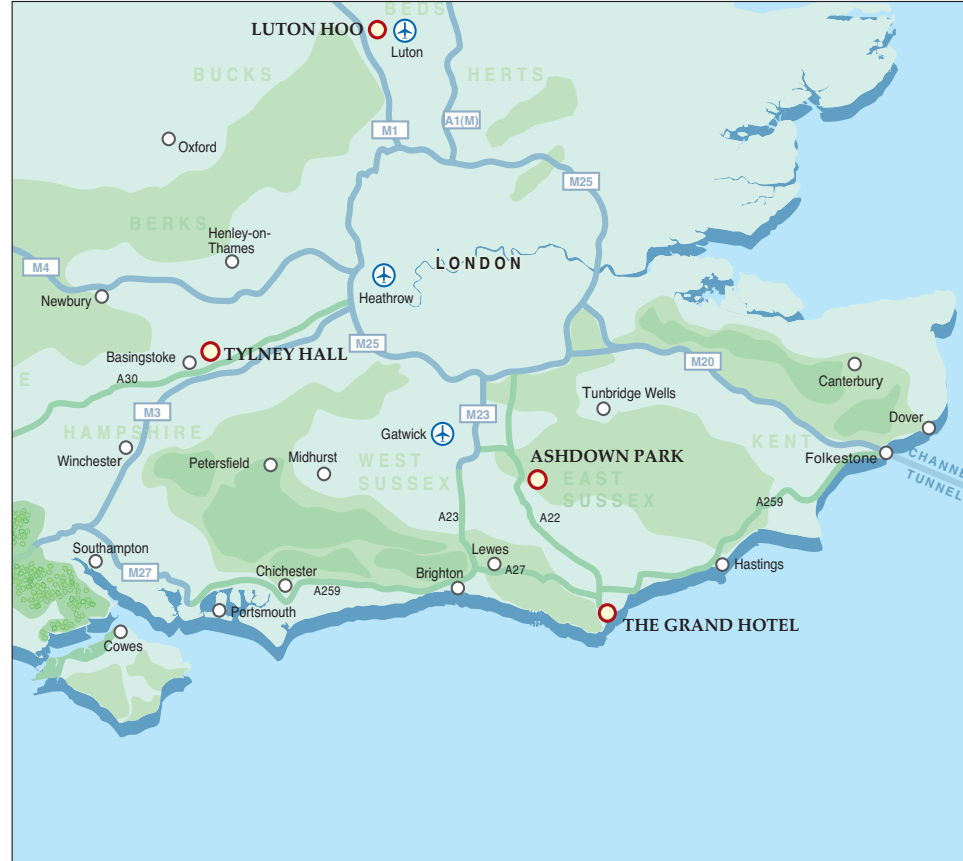

BY ROAD:

Route A M3 Junction 5, take A287 to Newnham and Basingstoke, straight on at junction with A30, by the Hoggett public house, into Old School Road. Over railway bridge, follow left signs to Newnham and Rotherwick. At Newnham Green, turn right at cross-roads. Tylney Hall will be found after one mile on the left hand side.

Route B M4 Junction 11, take A33 to Basingstoke. Turn left at end of dual carriageway, take B3349 towards Hook through Heckfield, Mattingley and Rotherwick. At the end of the village, just after the pond turn left towards Newnham. Tylney Hall is one mile on the right.

BY RAIL:

Basingstoke Station (6 miles)
To Waterloo and Southampton. Taxis available.
Hook Station (2 1/2 miles) Taxis must be pre-booked.

BY AIR:

Heathrow via M3 Motorway 40 mins.
Gatwick via M3/M25/M23 1 hour.
Farnborough via M3 20 mins.

BY HELICOPTER:

Grid ref: SK707551 o/s map no.186.

BY TAXI:

From hotel by prior arrangement.

CAR HIRE:

From hotel by prior arrangement.



Tylney Hall

★★★★

Rotherwick, Hook, Hampshire, RG27 9AZ

Telephone +44 (0)1256 764881 Facsimile +44 (0)1256 768141

E-mail conference@tylneyhall.com Website www.tylneyhall.com



INVESTOR IN PEOPLE